



**TEMPORARY STRIPING NOTES:**

**CONSTRUCTION NOTES:**

- ALL STRIPING SHALL CONFORM TO THE 2014 CA MUTCD AND SHALL BE INSTALLED WITH THERMOPLASTIC PER LADOT SPECIFICATIONS
1. REMOVE ALL CONFLICTING STRIPING PRIOR TO INSTALLATION OF WTCP/TCP.
2. WHEN REMOVAL IS REQUIRED BY CONSTRUCTION, CROSSWALK MARKINGS AND PEDESTRIAN SIGNAL HEADS SHALL BE REMOVED SIMULTANEOUSLY.
3. BUBBLE NOTES ARE:
  - 1 INSTALL TYPE VI ARROW PER FIGURE 3B-24(CA).
  - 2 INSTALL 4" WHITE EDGE LINE, DETAIL 27B.
  - 3 INSTALL 12" WHITE DIAGONAL LINE AT 24' SPACING.
  - 4 INSTALL 4" DOUBLE YELLOW LINE, WITH TWO WAY YELLOW RETROREFLECTIVE MARKERS, DETAIL 22.
  - 5 INSTALL 4" YELLOW TWO WAY LEFT TURN, WITH TWO WAY YELLOW RETROREFLECTIVE MARKERS, DETAIL 32.
  - 6 INSTALL 6" WHITE BIKE LANE, DETAIL 39.
  - 7 INSTALL BIKE SYMBOL PER FIGURE 9C-3.
  - 8 INSTALL 8" WHITE CHANNELIZING LINE, DETAIL 38.
  - 9 INSTALL 6" WHITE BIKE LANE INTERSECTION LINE, DETAIL 39A.
  - 10 INSTALL TYPE I ARROW PER FIGURE 3B-24(CA).
  - 11 INSTALL TYPE III(L) ARROW PER FIGURE 3B-24(CA).
  - 12 INSTALL TYPE III(R) ARROW PER FIGURE 3B-24(CA).
  - 13 INSTALL 4" WHITE CAT TRACK DETAIL 40.
  - 14 INSTALL 12" WHITE LIMIT LINE.
  - 15 INSTALL 4" WHITE EDGELINE EXTENSION DETAIL 27C.
  - 16 INSTALL 12" WHITE CHEVRON LINES AT 24' SPACING.
  - 17 INSTALL GREEN PAINT.
  - 18 INSTALL 12" YELLOW DIAGONAL.
  - 19 INSTALL DOUBLE YELLOW CENTERLINE WITH TWO-WAY YELLOW RETROREFLECTIVE MARKERS, DETAIL 29.
  - 20 INSTALL PAVEMENT MARKING PER CA MUTCD FIG 3B-23.

1. SEE SHEET 1 FOR WORKSITE TRAFFIC CONTROL PLANS NOTES & LEGEND.
2. CRASH CUSHION ARRAY "TS11" PER CALTRANS STD. PLAN T2 (SEE SHEET 1 FOR INSTALLATION DETAILS).
3. K-RAIL TO BE INSTALLED WITHOUT FENCE OR SCREEN TO MAINTAIN VISIBILITY.
4. INSTALL TEMPORARY ADA COMPLIANT CURB RAMP OR APPROVED EQUAL.
5. CONTRACTOR SHALL COORDINATE WITH THE IMPACTED TRANSIT OPERATOR(S) PRIOR TO PLAN ACCEPTANCE WHEN ANY EXISTING BUS STOP WILL BE AFFECTED BY CONSTRUCTION ACTIVITIES OR THE PROPOSED IMPROVEMENTS. PROVIDE TWO-WEEK ADVANCE NOTICE FOR POSSIBLE RELOCATION/ABANDONMENTS OF A BUS STOP. FOR METRO BUS STOPS, CONTACT DAVID DANIELS OF METRO BUS STOPS AND ZONES DEPARTMENT AT DANIELSD@METRO.NET.
6. CONTRACTOR SHALL NOTIFY ALL AFFECTED RESIDENTS, LAPD, LAFD, SCHOOLS, COUNCIL OFFICES AND BUSINESS FIVE (5) WORKING DAYS PRIOR TO START OF WORK.
7. CONTRACTOR SHALL MAINTAIN DRIVEWAY ACCESS FOR PROJECT DURATION. CONTRACTOR SHALL NOTIFY PROJECT OWNER OF CONSTRUCTION PRIOR TO START OF WORK.
8. MINIMUM 5' PEDESTRIAN WALKWAY.
9. CONTRACTOR SHALL CONTACT THE ACTIVE TRANSPORTATION DIVISION AT SHAHIN.KHAJAVI@LACITY.ORG AND CHARLIE.HO@LACITY.ORG FOR INSPECTION OF ROADWAY CONDITION, APPROVAL OF GREEN BICYCLE PAINT USE, AND GREEN BICYCLE PAINT SPECIFICATION (15) DAYS PRIOR TO BIKE LANE INSTALLATION. THE CONTRACTOR MAY BE REQUIRED TO RESURFACE ROADWAY PRIOR TO INSTALLATION OF THIS STRIPING PLAN AS DETERMINED BY LADOT & BSS.

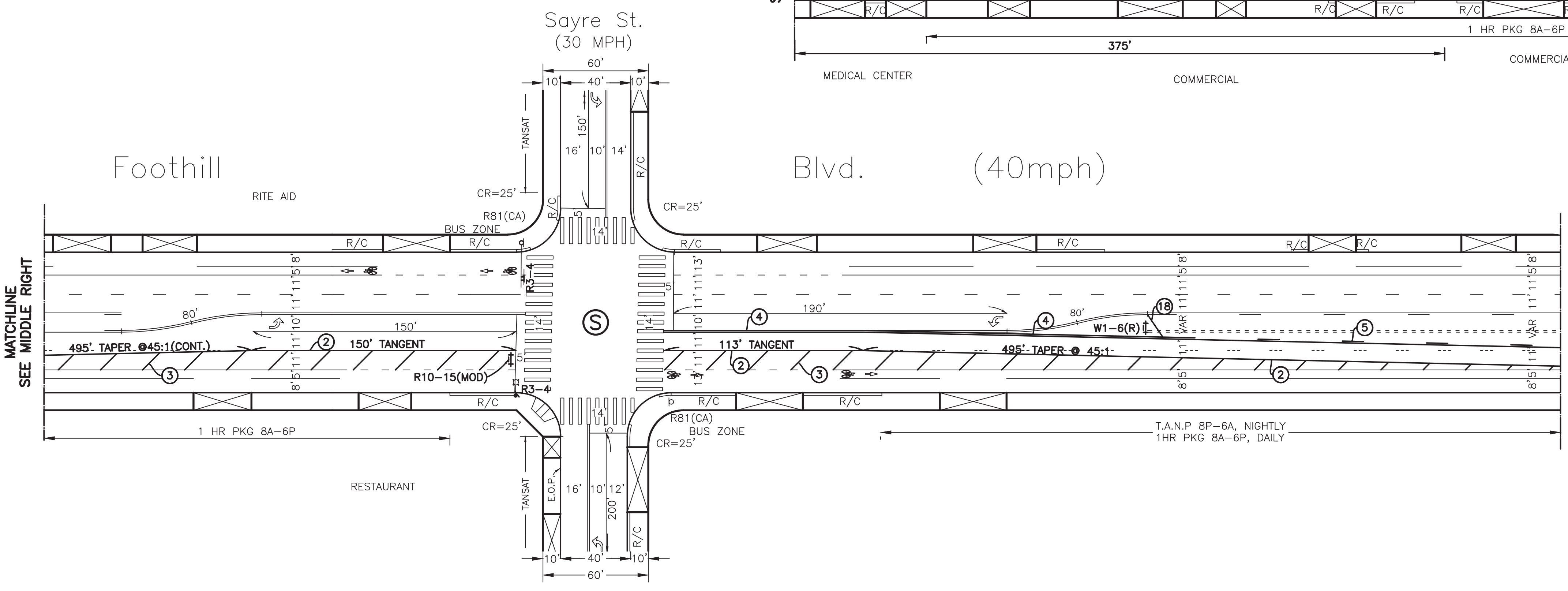
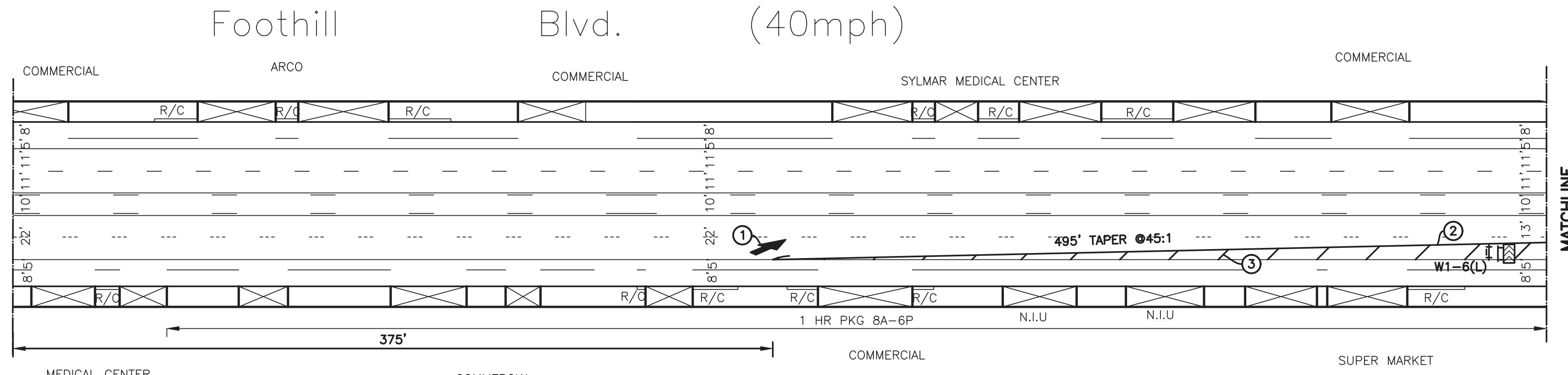
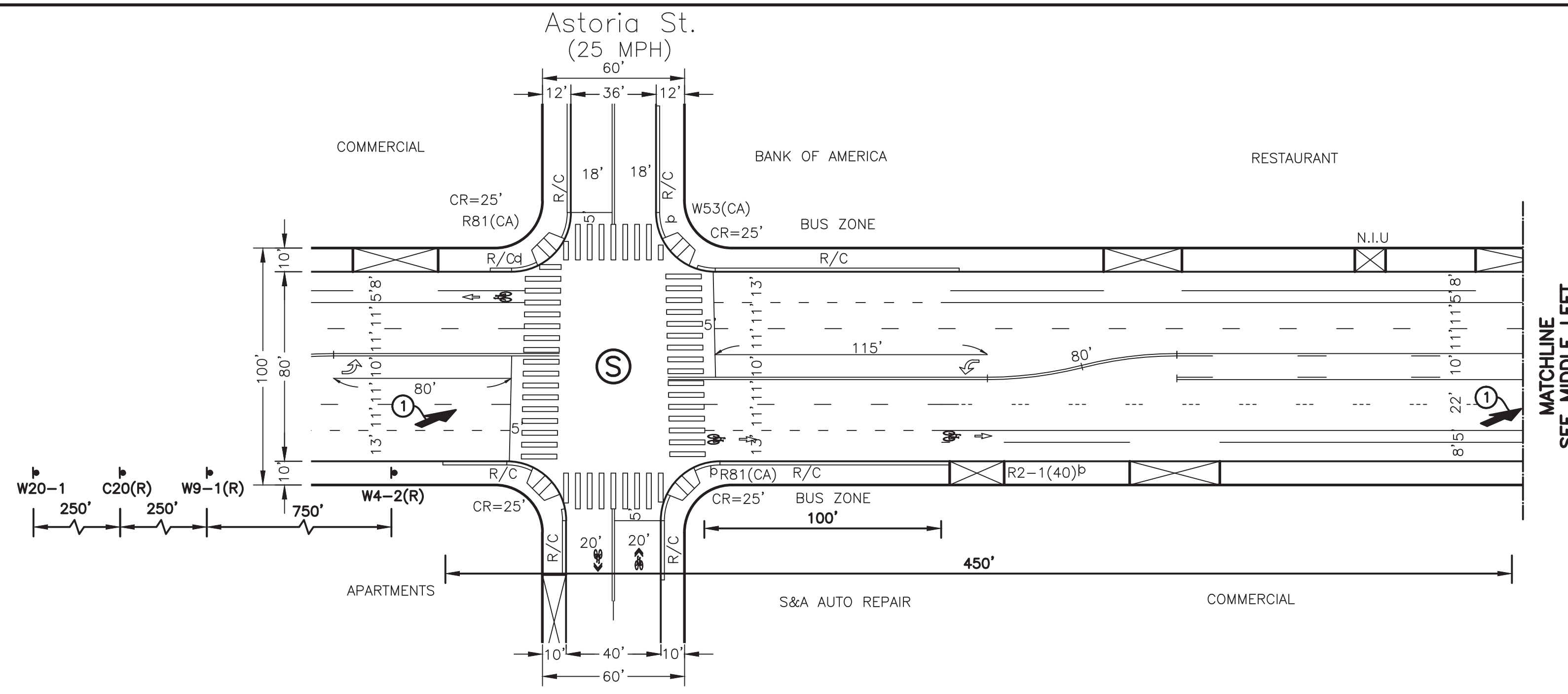

DO NOT ENTER	NO STOPPING ANY TIME
R5-1	R28(S)(CA)
WRONG WAY	WRONG WAY
OM4-3	R5-1a
ROAD WORK AHEAD	RIGHT LANE MUST TURN RIGHT
W20-1	R3-7
LANE CLOSED	RIGHT LANE ENDS
W4-2(RT)	W9-1(RT)
C30(CA)	G20-2
BEGIN	DETOUR
R81A(CA)	M4-9b(R)
SIDEWALK CLOSED	DETOUR
R9-9	OM-3R
ON RED	DETOUR
R13A	M4-9b(L)
END	W31(CA)
TURNING PEDESTRIAN	
R10-15(MOD)	

TEMPORARY TRAFFIC CONTROL STAGE 2  
 PROJECT ADDRESS: 13677 FOOTHILL BLVD, SYLMAR, CA 91342  
 ESTIMATED CONSTRUCTION DURATION: 18 MONTHS

REVIEWED	April 18, 2022	ACCEPTED	April 18, 2022
CITY OF LOS ANGELES DEPARTMENT OF TRANSPORTATION SELETA J. REYNOLDS, GENERAL MANAGER			
FOOTHILL BLVD BET HUBBARD ST & SAYRE ST			
IF THIS PLAN HAS NOT BEEN IMPLEMENTED WITHIN TWO (2) YEARS OF THE ACCEPTANCE DATE, IT MUST BE RESUBMITTED TO LADOT PERMIT PLAN REVIEW SECTION FOR REVIEW AND MAY REQUIRE A SUBSEQUENT ACCEPTANCE.			
References:	Thomas Guide	District	PROJECT NO.
A-4602	482-	VALLEY	NON B-PERMIT
A-6285			DRAWING NO.
A-8237			D-0834
			2
			6

Pursuant to the State of California Professional Engineering Act, Business and Professional Code Section 6703, the Responsible Charge of Work for the Engineer of Record includes the investigation of site conditions necessary to support the design of professional engineering related work.

Plans Prepared by:

**JMD**  
 PLANNING | ENGINEERING | MANAGEMENT  
 18645 East Gale Avenue, Suite 212  
 City of Industry, CA 91748  
 (626) 820-1137 Tel  
 (626) 820-1136 Fax  
 www.jmdiaz.com



**CONSTRUCTION NOTES:**

- SEE SHEET 1 FOR WORKSITE TRAFFIC CONTROL PLANS NOTES & LEGEND.
- CRASH CUSHION ARRAY "TS11" PER CALTRANS STD. PLAN T2 (SEE SHEET 1 FOR INSTALLATION DETAILS).
- K-RAIL TO BE INSTALLED WITHOUT FENCE OR SCREEN TO MAINTAIN VISIBILITY.
- INSTALL TEMPORARY ADA COMPLIANT CURB RAMP OR APPROVED EQUAL.
- CONTRACTOR SHALL COORDINATE WITH THE IMPACTED TRANSIT OPERATOR(S) PRIOR TO PLAN ACCEPTANCE WHEN ANY EXISTING BUS STOP WILL BE AFFECTED BY CONSTRUCTION ACTIVITIES OR THE PROPOSED IMPROVEMENTS. PROVIDE TWO-WEEK ADVANCE NOTICE FOR POSSIBLE RELOCATION/ABANDONMENTS OF A BUS STOP. FOR METRO BUS STOPS, CONTACT DAVID DANIELS OF METRO BUS STOPS AND ZONES DEPARTMENT AT DANIELSD@METRO.NET.
- CONTRACTOR SHALL NOTIFY ALL AFFECTED RESIDENTS, LAPD, LAFD, SCHOOLS, COUNCIL OFFICES AND BUSINESS FIVE (5) WORKING DAYS PRIOR TO START OF WORK.
- CONTRACTOR SHALL MAINTAIN DRIVEWAY ACCESS FOR PROJECT DURATION. CONTRACTOR SHALL NOTIFY PROJECT OWNER OF CONSTRUCTION PRIOR TO START OF WORK.
- MINIMUM 5' PEDESTRIAN WALKWAY.
- CONTRACTOR SHALL CONTACT THE ACTIVE TRANSPORTATION DIVISION AT SHAHIN.KHAJAVI@LACITY.ORG AND CHARLIE.HO@LACITY.ORG FOR INSPECTION OF ROADWAY CONDITION, APPROVAL OF GREEN BICYCLE PAINT USE, AND GREEN BICYCLE PAINT SPECIFICATION (15) DAYS PRIOR TO BIKE LANE INSTALLATION. THE CONTRACTOR MAY BE REQUIRED TO RESURFACE ROADWAY PRIOR TO INSTALLATION OF THIS STRIPING PLAN AS DETERMINED BY LADOT & BSS.

**TEMPORARY STRIPING NOTES:**

- ALL STRIPING SHALL CONFORM TO THE 2014 CA MUTCD AND SHALL BE INSTALLED WITH THERMOPLASTIC PER LADOT SPECIFICATIONS
- REMOVE ALL CONFLICTING STRIPING PRIOR TO INSTALLATION OF WTCP/TCP.
  - WHEN REMOVAL IS REQUIRED BY CONSTRUCTION, CROSSWALK MARKINGS AND PEDESTRIAN SIGNAL HEADS SHALL BE REMOVED SIMULTANEOUSLY.
  - BUBBLE NOTES ARE:
    - INSTALL TYPE VI ARROW PER FIGURE 3B-24(CA).
    - INSTALL 4" WHITE EDGE LINE, DETAIL 27B.
    - INSTALL 12" WHITE DIAGONAL LINE AT 24' SPACING.
    - INSTALL 4" DOUBLE YELLOW LINE, WITH TWO WAY YELLOW RETROREFLECTIVE MARKERS, DETAIL 22.
    - INSTALL 4" YELLOW TWO WAY LEFT TURN, WITH TWO WAY YELLOW RETROREFLECTIVE MARKERS, DETAIL 32.
    - INSTALL 6" WHITE BIKE LANE, DETAIL 39.
    - INSTALL BIKE SYMBOL PER FIGURE 9C-3.
    - INSTALL 8" WHITE CHANNELIZING LINE, DETAIL 38.
    - INSTALL 6" WHITE BIKE LANE INTERSECTION LINE, DETAIL 39A.
    - INSTALL TYPE I ARROW PER FIGURE 3B-24(CA).
    - INSTALL TYPE III(L) ARROW PER FIGURE 3B-24(CA).
    - INSTALL TYPE III(R) ARROW PER FIGURE 3B-24(CA).
    - INSTALL 4" WHITE CAT TRACK DETAIL 40.
    - INSTALL 12" WHITE LIMIT LINE.
    - INSTALL 4" WHITE EDGELINE EXTENSION DETAIL 27C.
    - INSTALL 12" WHITE CHEVRON LINES AT 24' SPACING.
    - INSTALL GREEN PAINT.
    - INSTALL 12" YELLOW DIAGONAL.
    - INSTALL DOUBLE YELLOW CENTERLINE WITH TWO-WAY YELLOW RETROREFLECTIVE MARKERS, DETAIL 29.
    - INSTALL PAVEMENT MARKING PER CA MUTCD FIG 3B-23.

R5-1	R28(S)(CA)
OM4-3	R5-1a
W20-1	R3-7
W4-2(RT)	W9-1(RT)
C30(CA)	G20-2
R81A(CA)	M4-9b(R)
R9-9	OM-3R
R13A	M4-9b(L)
R3-4	W31(CA)
R10-15(MOD)	

Foothill Blvd. (40mph)

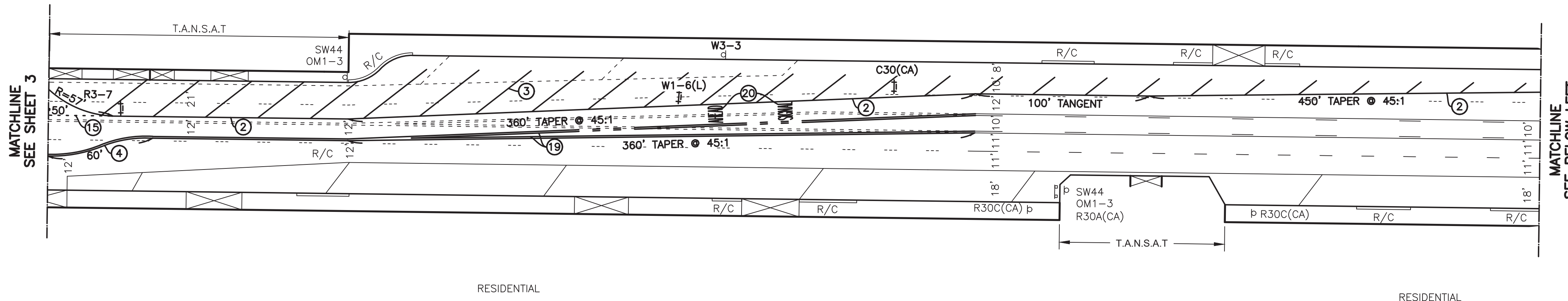

Foothill Blvd. (40mph)

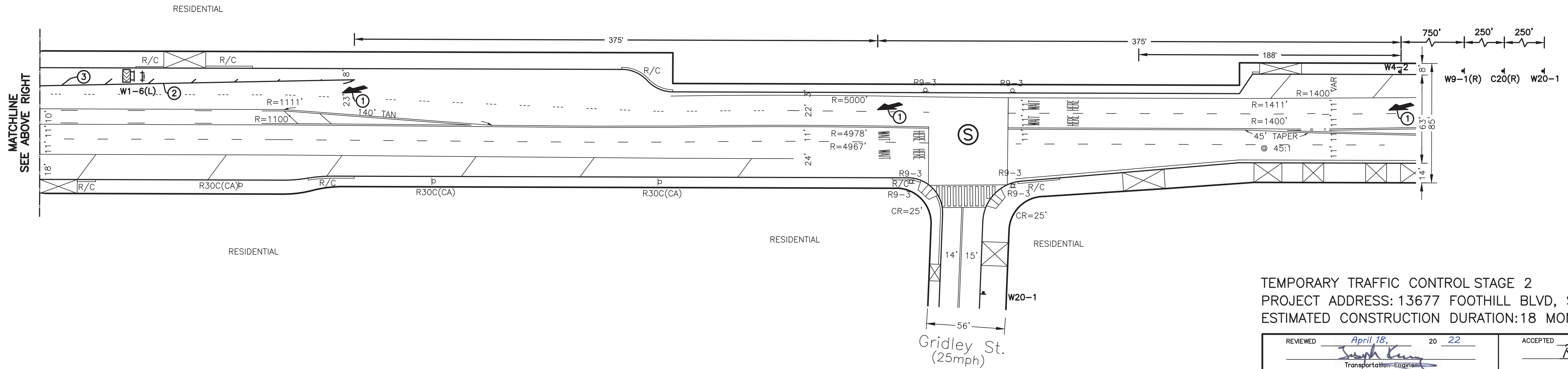

TEMPORARY TRAFFIC CONTROL STAGE 2  
 PROJECT ADDRESS: 13677 FOOTHILL BLVD, SYLMAR, CA 91342  
 ESTIMATED CONSTRUCTION DURATION: 18 MONTHS

REVIEWED	April 18, 20 22	ACCEPTED	April 18, 20 22
<i>Suph King</i> Transportation Engineer		<i>Randall Tays</i> Senior Transportation Engineer	
CITY OF LOS ANGELES DEPARTMENT OF TRANSPORTATION SELETA J. REYNOLDS, GENERAL MANAGER			
FOOTHILL BLVD BET HUBBARD ST & SAYRE ST			
IF THIS PLAN HAS NOT BEEN IMPLEMENTED WITHIN TWO (2) YEARS OF THE ACCEPTANCE DATE, IT MUST BE RESUBMITTED TO LADOT PERMIT PLAN REVIEW SECTION FOR REVIEW AND MAY REQUIRE A SUBSEQUENT ACCEPTANCE.			
References:	A-4602	A-6285	A-8237
Thomas Guide	482-B, B3, B4, C4	District	E.VAZAIEVEY
PROJECT NO.	NON B-PERMIT	DRAWING NO.	D-0834
DATE		BY	
REVIEWED	DATE	DATE	DATE
CHECK	DESIGN	REVISION	DESCRIPTION

Pursuant to the State of California Professional Engineering Act, Business and Professional Code Section 6703, the Responsible Charge of Work for the Engineer of Record includes the investigation of site conditions necessary to support the design of professional engineering related work.

Plans Prepared by:

**JMD**  
PLANNING | ENGINEERING | MANAGEMENT  
18645 East Gale Avenue, Suite 212  
City of Industry, CA 91748  
(626) 820-1137 Tel  
(626) 820-1138 Fax  
www.jmdiaz.com

REGISTERED PROFESSIONAL ENGINEER  
JUAN M. DIAZ  
No. 50813  
CIVIL  
STATE OF CALIFORNIA  
EXPIRES: 09/30/23

REGISTERED PROFESSIONAL ENGINEER  
STEVEN O. ITAKANY  
No. 2194  
TRAFFIC  
STATE OF CALIFORNIA  
EXPIRES: 06/30/23



DRAFT - NOT FOR CONSTRUCTION

INDEX NUMBER AS-BID

SIGNAL STANDARD SCHEDULE				
No.	TYPE	FOUND. TYPE	PED. PUSH BUTN TYPE	REMARKS
1	332 CAB.	F-332	-	ATSAC 2070 CONTROLLER IN 332 CABINET
2	26-3-70	CIDH	APS	RELOCATE LT SIGNAL HEAD TO F=20'
3	1	F-1	APS	
4	19-3-70	CIDH	APS	25' M.A.
5	C-1-100	CIDH	APS	CCTV CAMERA W/12' ARM & APS
6	26-4-100	CIDH	APS	REMOVE CUSTOM 30' M.A. & APS
7	CD953	BSL	APS	
8	26-3-70	CIDH	APS	45' M.A., F=20', CUSTOM 27' STD.
9	CD953	BSL	APS	
10	CD954	PLATFORM	-	15' MAST ARM.

\* Existing  
 \*\* Per LADOT Standard Dwg. No. S-57.2C

**NOTES :**

- SEMI-ACTUATED OPERATION WITH ATSAC CAMERA (ATSAC 2070 CONTROLLER IN 332 CABINET)  
 01 - FOOTHILL BLVD. EB LT  
 02 - FOOTHILL BLVD. WB & N/S PED. XING  
 03 - HUBBARD ST. NB LT  
 04 - HUBBARD ST. SB & W/S PED. XING  
 05 - FOOTHILL BLVD. WB LT  
 06 - FOOTHILL BLVD. EB & S/S PED. XING  
 07 - HUBBARD ST. SB LT  
 08 - HUBBARD ST. NB & E/S PED. XING  
 FOOTHILL ATSAC SYSTEM  
 ATSAC CABLE INTERCONNECT

- CONTRACTOR MAY RE-USE EXISTING STUB-OUT AS DETERMINED BY THE TRAFFIC SIGNAL INSPECTOR. IF STUB-OUT IS NOT IN PLACE OR DAMAGED, CONTRACTOR SHALL INSTALL NEW STUB-OUT PER LADOT STD. DWG. S-70.1A.
- INSTALL DETECTOR LOOP(S) PER LADOT STD. DWG. NO. S-70.1A & S-70.1D (CASE II).
- THE CONTRACTOR SHALL CONTACT THE LADOT VALLEY YARD TRAFFIC SIGNAL INSPECTOR AT (213) 216-9322 FIFTEEN (15) WORKING DAYS PRIOR TO START OF CONSTRUCTION FOR FIELD MODIFICATION OF CONTROLLER. TIMING CHANGES SHALL BE IMPLEMENTED PRIOR TO START OF CONSTRUCTION.

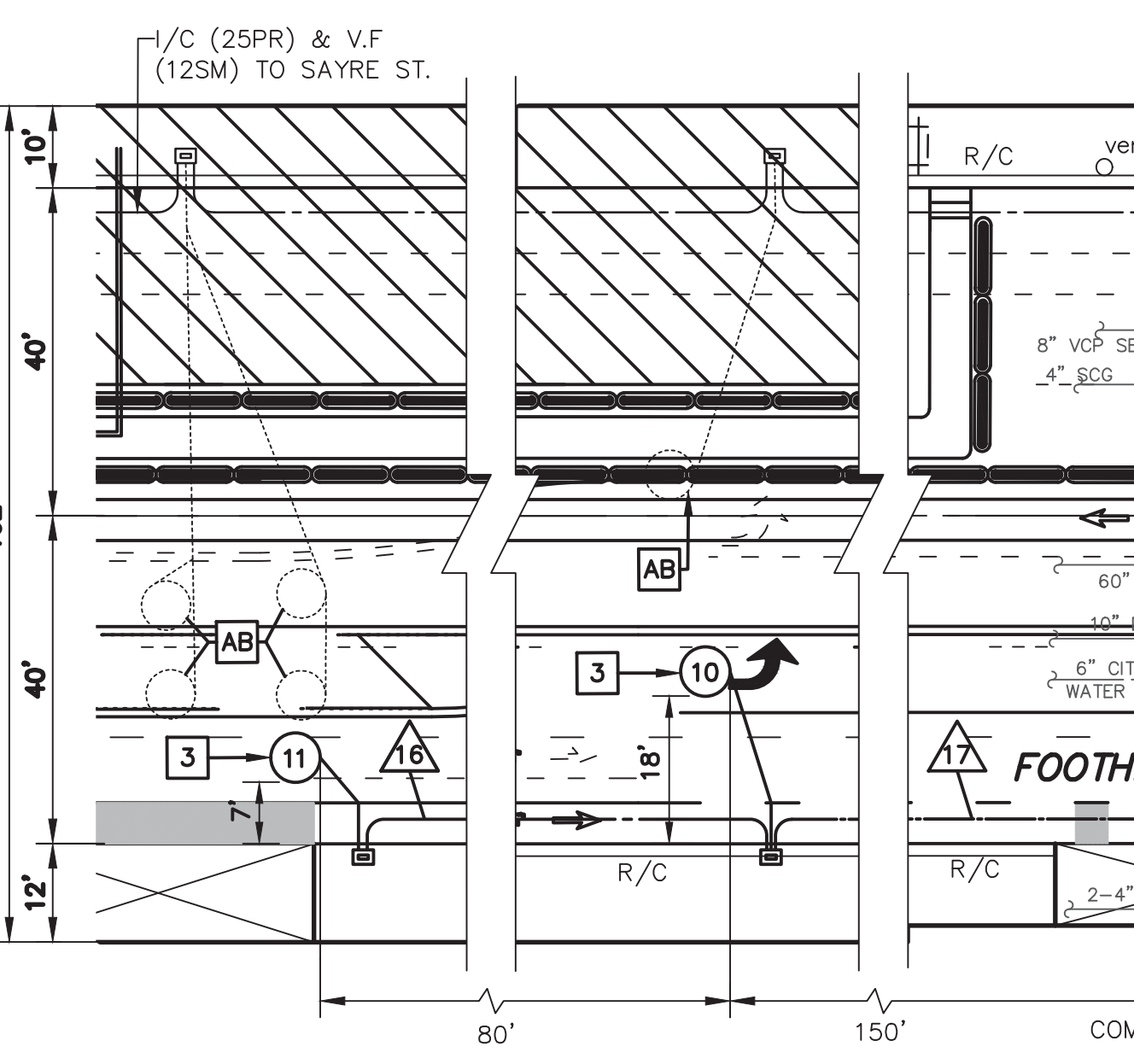

- DISCONNECT DETECTOR LOOP(S) IN PULL BOX.
- TEMPORARY SIGNAL PLATFORM SHALL BE PLACED AS SHOWN WITH A MINIMUM 2' CLEARANCE FROM THE FACE OF THE PLATFORM TO THE EDGE OF THE TRAVELED ROADWAY (15' CLEARANCE IF NOT PROTECTED BY CRASH CUSHION OR BEHIND K-RAIL OR CURB). OVERHEAD CABLES SHALL MAINTAIN A 20' VERTICAL CLEARANCE ABOVE THE TRAVELED ROADWAY AND 12' CLEARANCE OVER THE SIDEWALK. COIL AN ADDITIONAL 25' LENGTH OF OVERHEAD CABLE AT THE TEMPORARY PLATFORM SIGNAL TO FACILITATE CHANGE IN POSITION. ALTERNATE LOCATIONS OF THE TEMPORARY SIGNAL EQUIPMENT, BASED ON CONSTRUCTION CONDITION, REQUIRES APPROVAL OF THE LADOT TRAFFIC SIGNAL INSPECTOR.
- CONTRACTOR MAY RE-USE THE EXISTING DLC IN THE PULL BOX AS DETERMINED BY THE TRAFFIC SIGNAL INSPECTOR. IF DLC CABLE IS DAMAGED, NEW DLC CABLE SHALL BE INSTALLED FROM THE PULL BOX TO THE CONTROLLER.
- REMOVE, MARKOUT AND INSTALL ALL SIGNS, STRIPING AND PAVEMENT MARKINGS PER LADOT GEOMETRIC PLAN NO. D-0834 AND THIS SIGNAL PLAN.

Pursuant to the State of California Professional Engineering Act, Business and Professional Code Section 6703, the Responsible Charge of Work for the Engineer of Record includes the investigation of site conditions necessary to support the design of professional engineering related work.

Plans Prepared by:

JMD  
 PLANNING | ENGINEERING | MANAGEMENT  
 18645 East Gate Avenue, Suite 212  
 City of Industry, CA 91748  
 (626) 820-1137 Tel  
 (626) 820-1138 Fax  
 www.jmdaz.com

REGISTERED PROFESSIONAL ENGINEER  
 JUAN M. DIAZ  
 No. 50813  
 CIVIL  
 STATE OF CALIFORNIA  
 EXPIRES: 09/30/23

REGISTERED PROFESSIONAL ENGINEER  
 STEVEN O. ITAGAKI  
 No. 2794  
 TRAFFIC  
 STATE OF CALIFORNIA  
 EXPIRES: 06/30/23

CITY OF LOS ANGELES BUSINESS TAX REGISTRATION NO: 12872

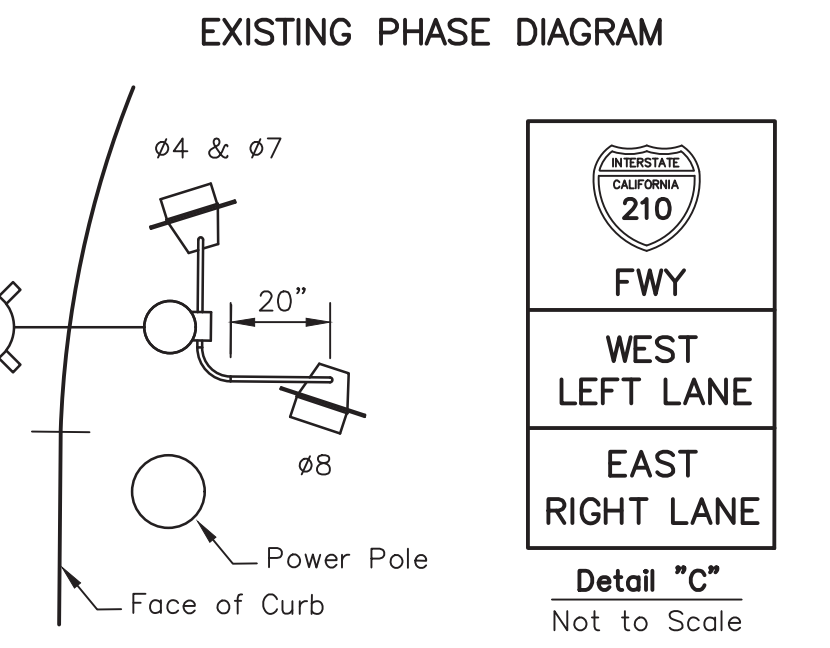
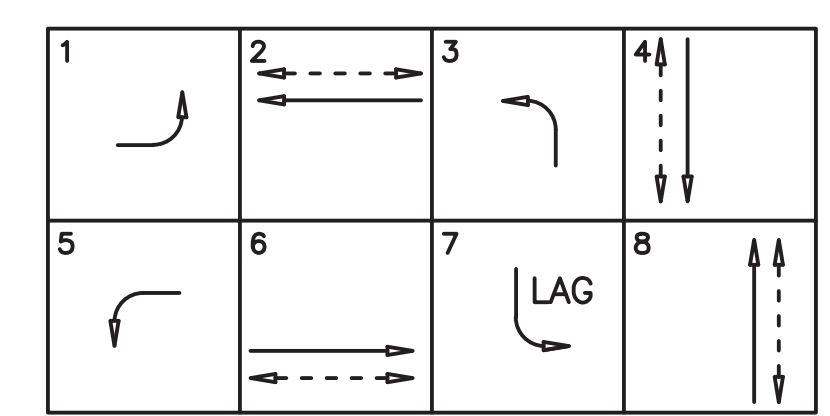
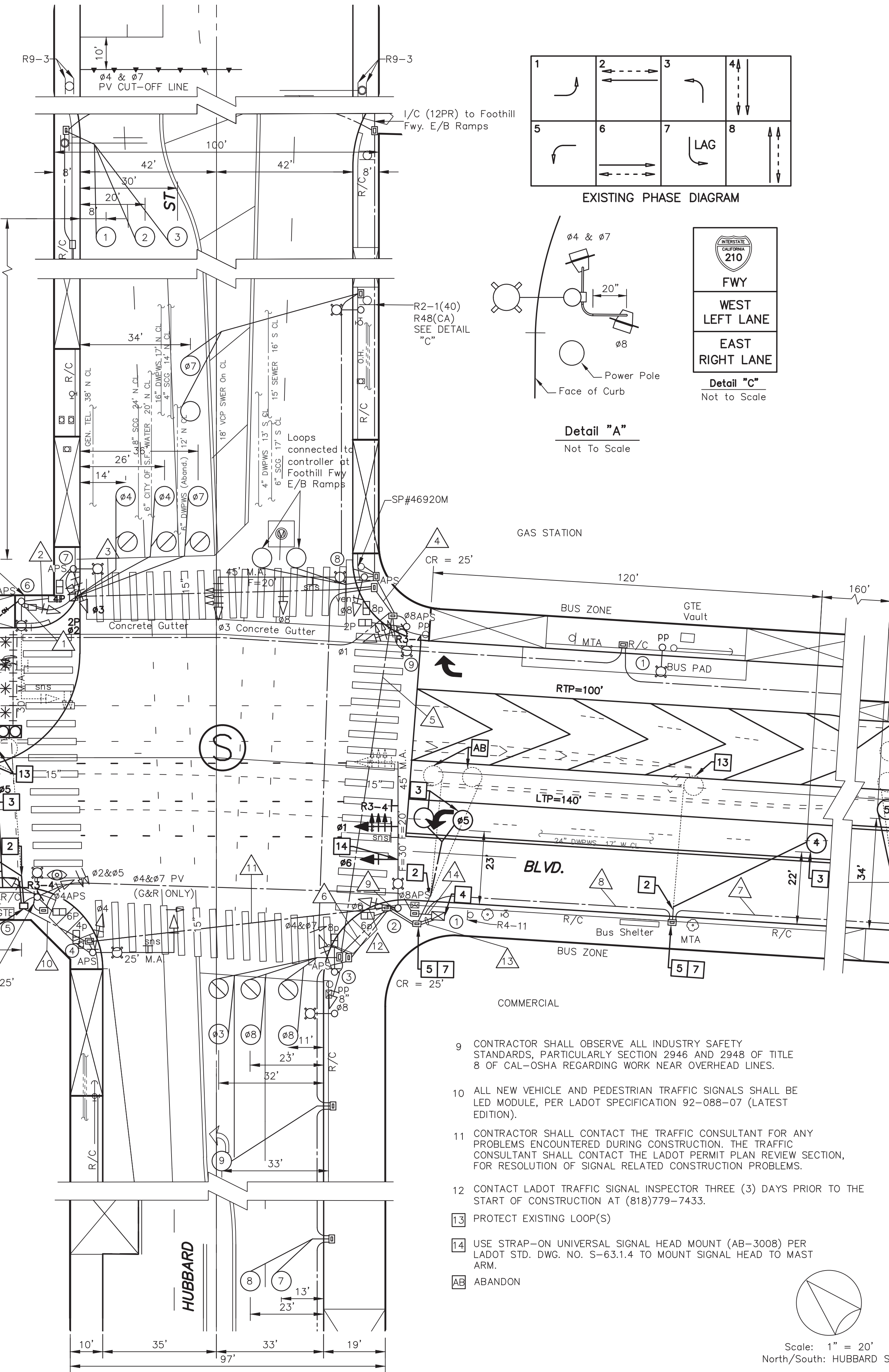

Detail "A"  
 Not To Scale

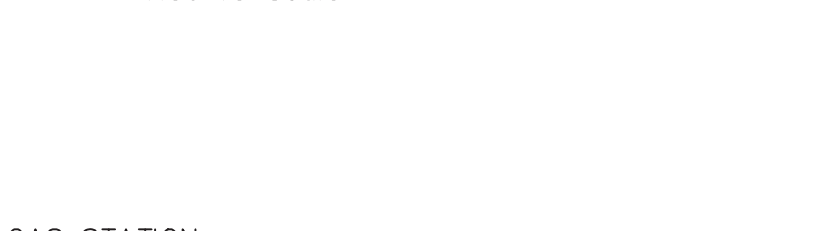

Detail "C"  
 Not to Scale

CONDUCTOR SCHEDULE		RUN											
SIZE No.	CABLE / WIRE	1	2	3	4	5	6	7	8	9	10	11	12
3	CONDUCTOR CABLE 3 X #14												
5	CONDUCTOR CABLE 5 X #14												
13	CONDUCTOR CABLE 12 X #14 & 1 X #10 (COM)	1	1	1	1	1	1	1	1	1	1	1	1
28	CONDUCTOR CABLE 27 X #14 & 1 X #10 (COM)												
6	SERVICE												
8	SERVICE												
12	BUS DLC (1-PAIR)												
18	DLC (2 PAIR)												
18	DLC (3 PAIR)												
18	DLC (4 PAIR)												
14	DLC (EXISTING)												
22	I/C (12 PAIR)												
22	I/C (25 PAIR)												
22	I/C (50 PAIR)												
	VIDEO FIBER (12SM)												
	CCTV CABLE												
	FIBER OPTIC												
	PULL ROPE												
	CONDUIT SIZE	2"	2"	2"	2"	2"	2"	2"	2"	2"	2"	2"	2"

\* CONTRACTOR SHALL ADD/INSTALL NEW CONDUCTORS/CABLES IN EXISTING CONDUIT AS DESIGNATED IN THE CONDUCTOR SCHEDULE. ALL EXISTING CONDUCTORS/CABLES SHALL BE PROTECTED AND MAINTAINED IN EXISTING CONDUITS.

**NOTICE TO CONTRACTOR**

- EXCEPT WHERE OTHERWISE INDICATED, MATERIALS AND INSTALLATION METHODS SHALL CONFORM TO THE LATEST EDITION WITH SUPPLEMENTS, OF THE STANDARD SPECIFICATIONS FOR PUBLIC WORKS CONSTRUCTION, ADOPTED BY THE CITY OF LOS ANGELES BOARD OF PUBLIC WORKS "ENHANCED ELECTRICAL SAFETY POLICY" AS REQUIRED IN LADOT'S SPECIAL PROVISIONS AND STANDARD DRAWINGS FOR THE INSTALLATION AND MODIFICATION OF TRAFFIC SIGNALS (RED BOOK), REGARDLESS OF CONTRACT COST.
- ALL TRAFFIC SIGNAL AND/OR RELATED ELECTRICAL WORK SHALL BE PERFORMED AND INSPECTED UNDER THE CONDITIONS OF THE MOST CURRENT AMENDED BOARD OF PUBLIC WORKS "ENHANCED ELECTRICAL SAFETY POLICY" AS REQUIRED IN LADOT'S SPECIAL PROVISIONS AND STANDARD DRAWINGS FOR THE INSTALLATION AND MODIFICATION OF TRAFFIC SIGNALS (RED BOOK), REGARDLESS OF CONTRACT COST.
- THE LADOT TRAFFIC SIGNAL INSPECTOR AT (818) 779-7433 SHALL BE NOTIFIED THREE (3) WORKING DAYS PRIOR TO THE BEGINNING OF CONSTRUCTION. FOR WORK IN THE AUTOMATED TRAFFIC SURVEILLANCE AND CONTROL (ATSAC) PROJECT AREA, A FIELD MEETING SHALL BE SCHEDULED WITH THE SIGNAL SYSTEM SUPERVISOR AT (213) 473-8286 AND THE SIGNAL MAINTENANCE SUPERVISOR AT (818) 779-7437 THREE (3) WORKING DAYS PRIOR TO THE BEGINNING OF CONSTRUCTION. FULL RESTORATION OF THE ATSAC SYSTEM MUST OCCUR WITHIN FIVE (5) WORKING DAYS AFTER SHUT DOWN.
- REGULAR TRAFFIC SIGNAL CONTROL SHALL BE MAINTAINED FROM 6:00 A.M. TO 9:00 A.M. AND 3:00 P.M. TO 7:00 P.M. ON WEEKDAYS, EXCEPT NATIONAL HOLIDAYS. FLASHING DEACTIVATION AND ACTIVATION OF SIGNALS SHALL BE ACCOMPLISHED ONLY BY AN LADOT TRAFFIC SIGNAL ELECTRICIAN. ALL ARRANGEMENTS TO DEACTIVATE SIGNALS SHALL BE MADE 24 HOURS IN ADVANCE BY CONTACTING THE LADOT TRAFFIC SIGNAL DEDICATED LINE AT (213) 485-9161 BEFORE 9:00 A.M. ON NON-HOLIDAY WEEKDAYS. THE LADOT PROJECT NUMBER MUST BE GIVEN AT THIS TIME. THE CONTRACTOR WILL BE CHARGED FOR ALL ELECTRICAL AND TRAFFIC CONTROL SERVICE PROVIDED BY LADOT.
- ARRANGEMENTS FOR OBTAINING ANY MATERIALS IDENTIFIED TO BE SUPPLIED BY LADOT SHALL BE MADE TEN (10) WORKING DAYS IN ADVANCE BY CONTACTING THE LADOT FIELD OPERATIONS DIVISION AT (213) 928-9603. HOWEVER, TRAFFIC SIGNAL CONTROLLERS REQUIRE SIXTY (60) WORKING DAYS ADVANCE NOTICE AND MUST BE PICKED UP WITHIN THIRTY (30) WORKING DAYS AFTER NOTIFICATION. CONTACT LADOT SIGNAL SHOP AT (213) 473-8468 TO COORDINATE CONTROLLER DELIVER AND/OR PICKUP.
- ALL IDENTIFIED TRAFFIC SIGNAL EQUIPMENT SHALL BE RETURNED TO LADOT. ARRANGEMENTS FOR RETURNING IDENTIFIED EQUIPMENT TO LADOT SHALL BE MADE FIVE (5) WORKING DAYS IN ADVANCE BY CONTACTING THE LADOT MATERIAL SERVICES DIVISION AT (213) 928-9636.
- ALL EXISTING TRAFFIC CONTROL SIGNING SHALL BE MAINTAINED WITH STANDARD SIGN BRACKETS BY THE CONTRACTOR. EXCEPT WHERE OTHERWISE INDICATED, EXISTING LARGE STREET NAME SIGNS ON MAST ARM TYPE STANDARDS SHALL BE RELOCATED FROM THE VERTICAL POLE TO THE MAST ARM PER LADOT STANDARD DRAWING NO. S-457.0 AND S-486.0. THE CONTRACTOR SHALL COORDINATE WITH LADOT SIGN SHOP AT (213) 473-7954 FOR ANY REQUIRED LARGE STREET NAME SIGNS. ANY TRAFFIC CONTROL SIGNING DAMAGED OR LOST BY THE CONTRACTOR SHALL BE REPLACED AT THE CONTRACTOR'S EXPENSE. SIGNAL CONTRACTOR SHALL INSTALL MAST ARM MOUNTED SIGNS. FOR THE INSTALLATION OF A STREET NAME SIGN ON A TYPE 1 POLE, THE CONTRACTOR SHALL FURNISH AND INSTALL A POLE EXTENSION AS NEEDED.
- THE CONTRACTOR SHALL FURNISH AND INSTALL, AS SHOWN ON THE PLANS, ALL TRAFFIC SIGNAL EQUIPMENT SUCH AS STANDARDS, MAST ARMS, SIGNAL HEADS, AND OTHER EQUIPMENT AS REQUIRED. ALL SUCH EQUIPMENT SHALL BE NEW. ALL VEHICLE HEAD EQUIPMENT SUPPLIED BY THE CONTRACTOR SHALL HAVE 1-1/2 INCH DIAMETER PIPE FIT MOUNTING HARDWARE, INCLUDING ALL TOP POST MOUNT HEADS, PED HEAD MODULE REPLACEMENTS SHOWN ON THE PLAN SHALL REQUIRE A COMPLETE INSTALLATION, INCLUDING NEW PED HEAD AND TERMINAL COMPARTMENT.

**TEMPORARY TRAFFIC SIGNAL ESTIMATED CONSTRUCTION DURATION: 18 MONTHS**

REVIEWED	April 18, 20 22	ACCEPTED	April 18, 20 22
<b>AS BUILT</b>		CITY OF LOS ANGELES	
Date of Installation:		DEPARTMENT OF TRANSPORTATION	
LADOT Inspector:		SELETA J. REYNOLDS, General Manager	
Condition As Of:		TITLE	
LADOT Engineer:		FOOTHILL BLVD. & HUBBARD ST.	
District: WEST VALLEY		Drawing No. 28320-2022-TEMP	
References:		Intersection No. 28320	
A-5865		Project No. PROPC000	
A-6285		28320-FOOTHILL 1-014	
NOTICE: IF PLAN HAS NOT BEEN IMPLEMENTED WITHIN TWO (2) YEARS OF THE ACCEPTANCE DATE, IT MUST BE RESUBMITTED TO LADOT PERMIT PLAN REVIEW SECTION FOR REVIEW AND ACCEPTANCE.			

(LADOT Revised 2/21)  
 (Drafting Std. 11/04)

DRAFT - NOT FOR CONSTRUCTION

SHEET 5 OF 6

INDEX NUMBER D-34074

NO.	REVISION	DESCRIPTION	DATE	T.E.	
				T.E.A.	S.T.E.

SIGNAL STANDARD SCHEDULE					
No.	TYPE	FOUND. TYPE	PED. PUSH BUTN TYPE	PHASE	REMARKS
1	332 CAB.	F-332	-	-	ATSAC 2070 CONTROLLER IN 332 CABINET
2	26-3-70	CIDH	APS	8	
3	1	F-1	APS	-	
4	19-3-70	CIDH	APS	-	25' M.A.
5	C-1-100	CIDH	APS	4	CCTV CAMERA W/12' ARM
6	26-4-100	CIDH	APS	4	REINSTALL CUSTOM 30' M.A.
7	CD953	BSL	APS	-	
8	26-3-70	CIDH	APS	-	45' M.A., F=20', CUSTOM 27' STD.
9	CD953	BSL	APS	8	

\* Existing  
 \*\* Per LADOT Standard Dwg. No. S-57.2C

**NOTES:**

- SEMI-ACTUATED OPERATION WITH ATSAC CAMERA (ATSAC 2070 CONTROLLER IN 332 CABINET)
  - 01 - FOOTHILL BLVD. EB LT
  - 02 - FOOTHILL BLVD. WB & N/S PED. XING
  - 03 - HUBBARD ST. NB LT
  - 04 - HUBBARD ST. SB & W/S PED. XING
  - 05 - FOOTHILL BLVD. WB LT
  - 06 - FOOTHILL BLVD. EB & S/S PED. XING
  - 07 - HUBBARD ST. SB LT
  - 08 - HUBBARD ST. NB & E/S PED. XING
- CONTRACTOR MAY RE-USE EXISTING STUB-OUT AS DETERMINED BY THE TRAFFIC SIGNAL INSPECTOR. IF STUB-OUT IS NOT IN PLACE OR DAMAGED, CONTRACTOR SHALL INSTALL NEW STUB-OUT PER LADOT STD. DWG. S-70.1A.
- INSTALL DETECTOR LOOP(S) PER LADOT STD. DWG. NO. S-70.1A & S-70.1D (CASE II).
- THE CONTRACTOR SHALL CONTACT THE LADOT VALLEY YARD TRAFFIC SIGNAL INSPECTOR AT (213) 216-9322 FIFTEEN (15) WORKING DAYS PRIOR TO START OF CONSTRUCTION FOR FIELD MODIFICATION OF CONTROLLER. TIMING CHANGES SHALL BE IMPLEMENTED PRIOR TO START OF CONSTRUCTION.

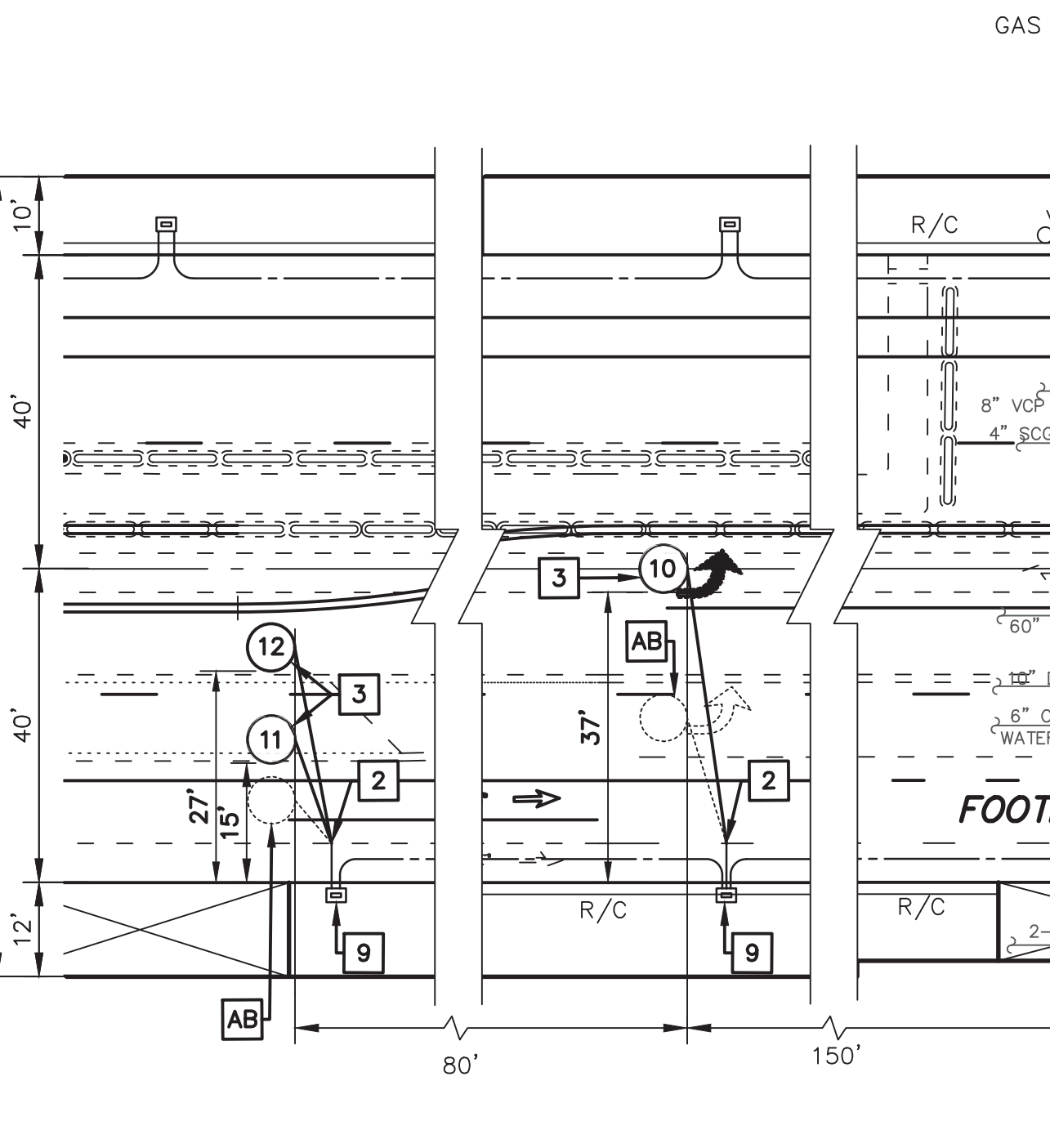

- CONTRACTOR SHALL OBSERVE ALL INDUSTRY SAFETY STANDARDS, PARTICULARLY SECTION 2946 AND 2948 OF TITLE 8 OF CAL-OSHA REGARDING WORK NEAR OVERHEAD LINES.
- ALL NEW VEHICLE AND PEDESTRIAN TRAFFIC SIGNALS SHALL BE LED MODULE, PER LADOT SPECIFICATION 92-088-07 (LATEST EDITION).
- CONTRACTOR SHALL CONTACT THE TRAFFIC CONSULTANT FOR ANY PROBLEMS ENCOUNTERED DURING CONSTRUCTION. THE TRAFFIC CONSULTANT SHALL CONTACT THE LADOT PERMIT PLAN REVIEW SECTION, FOR RESOLUTION OF SIGNAL RELATED CONSTRUCTION PROBLEMS.
- CONTACT LADOT TRAFFIC SIGNAL INSPECTOR THREE (3) DAYS PRIOR TO THE START OF CONSTRUCTION AT (818)779-7433.

Pursuant to the State of California Professional Engineering Act, Business and Professional Code Section 6703, the Responsible Charge of Work for the Engineer of Record includes the investigation of site conditions necessary to support the design of professional engineering related work.

Plans Prepared by:

18645 East Gate Avenue, Suite 212  
 City of Industry, CA 91748  
 (626)820-1137 Tel  
 (626)820-1136 Fax  
 www.jmdaz.com

EXPIRES: 09/30/23  
 EXPIRES: 06/30/23

CITY OF LOS ANGELES BUSINESS TAX REGISTRATION NO: 12872

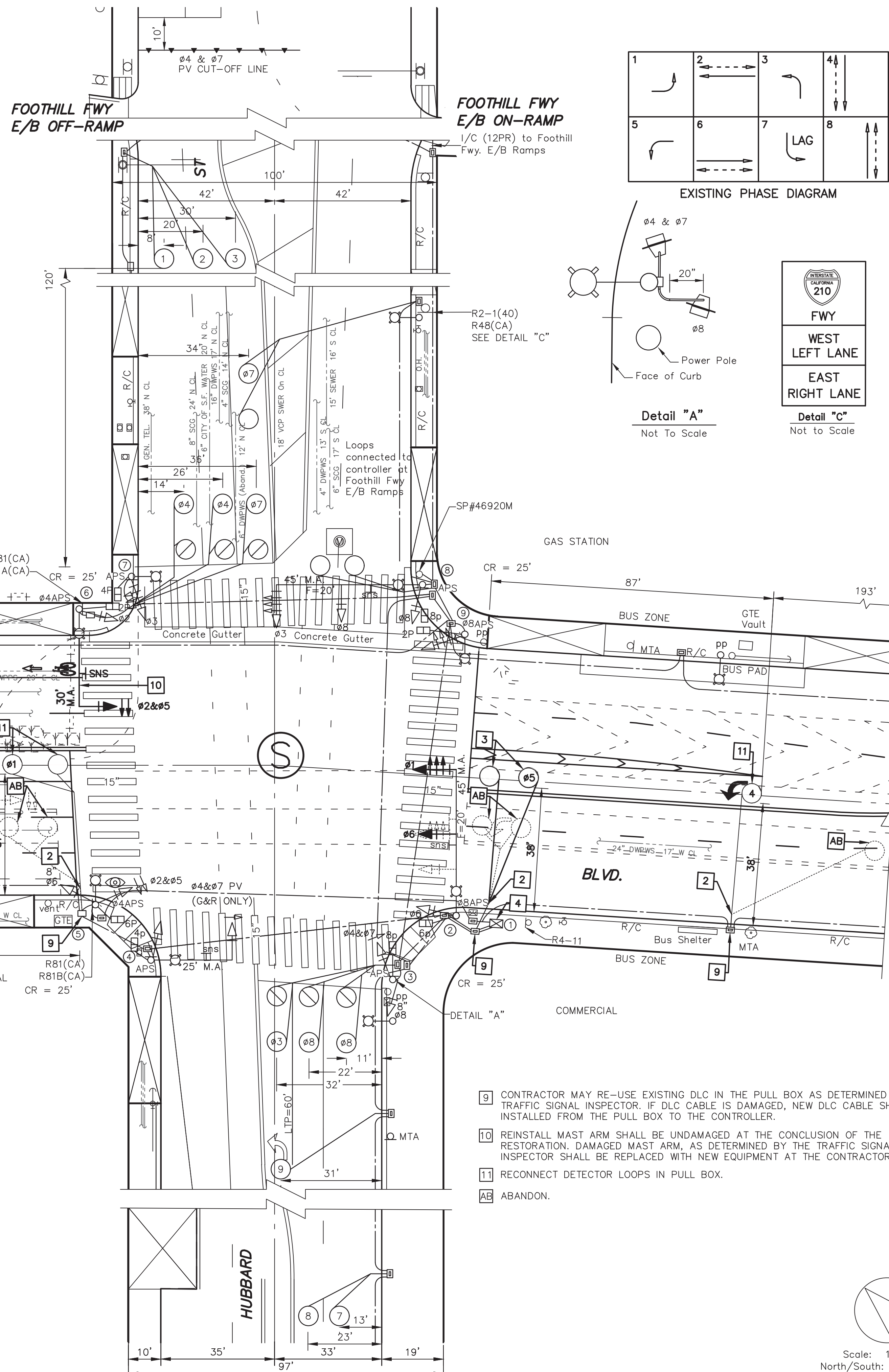

CONDUCTOR SCHEDULE	
SIZE No.	CABLE / WIRE
	3 CONDUCTOR CABLE 3 X #14
M	5 CONDUCTOR CABLE 5 X #14
U	13 CONDUCTOR CABLE 12 X #14 & 1 X #10 (COM)
L	28 CONDUCTOR CABLE 27 X #14 & 1 X #10 (COM)
T	6 SERVICE
I	8 SERVICE
	12 BUS DLC (1-PAIR)
	18 DLC (2 PAIR)
	18 DLC (3 PAIR)
	18 DLC (4 PAIR)
	14 DLC (EXISTING)
	22 I/C (12 PAIR)
	22 I/C (25 PAIR)
	22 I/C (50 PAIR)
	VIDEO FIBER (12SM)
	CCTV CABLE
	FIBER OPTIC
	PULL ROPE
	CONDUIT SIZE

ALL CONDUIT RUNS ARE EXISTING UNLESS INDICATED (\*) ABOVE, THE CONTRACTOR SHALL ADD/INSTALL NEW CONDUCTORS/CABLES AND PROTECT AND MAINTAIN ALL EXISTING CONDUCTORS/CABLES.

**NOTICE TO CONTRACTOR**

- EXCEPT WHERE OTHERWISE INDICATED, MATERIALS AND INSTALLATION METHODS SHALL CONFORM TO THE LATEST EDITION WITH SUPPLEMENTS, OF THE STANDARD SPECIFICATIONS FOR PUBLIC WORKS CONSTRUCTION, ADOPTED BY THE CITY OF LOS ANGELES BOARD OF PUBLIC WORKS (LABPW), INCLUDING THE LATEST VERSION OF THE "BROWN BOOK" ISSUED BY THE LABPW, AND THE LATEST EDITION, WITH AMENDMENTS, OF THE SPECIAL PROVISIONS AND STANDARD DRAWINGS FOR THE INSTALLATION AND MODIFICATION OF TRAFFIC SIGNALS, ISSUED BY THE CITY OF LOS ANGELES DEPARTMENT OF TRANSPORTATION (LADOT).
- ALL TRAFFIC SIGNAL AND/OR RELATED ELECTRICAL WORK SHALL BE PERFORMED AND INSPECTED UNDER THE CONDITIONS OF THE MOST CURRENT AMENDED BOARD OF PUBLIC WORKS "ENHANCED ELECTRICAL SAFETY POLICY" AS REQUIRED IN LADOT'S SPECIAL PROVISIONS AND STANDARD DRAWINGS FOR THE INSTALLATION AND MODIFICATION OF TRAFFIC SIGNALS (RED BOOK), REGARDLESS OF CONTRACT COST.
- THE LADOT TRAFFIC SIGNAL INSPECTOR AT (818) 779-7433 SHALL BE NOTIFIED THREE (3) WORKING DAYS PRIOR TO THE BEGINNING OF CONSTRUCTION. FOR WORK IN THE AUTOMATED TRAFFIC SURVEILLANCE AND CONTROL (ATSAC) PROJECT AREA, A FIELD MEETING SHALL BE SCHEDULED WITH THE SIGNAL SYSTEM SUPERVISOR AT (213) 473-9288 AND THE SIGNAL MAINTENANCE SUPERVISOR AT (818) 779-7437 THREE (3) WORKING DAYS PRIOR TO THE BEGINNING OF CONSTRUCTION. FULL RESTORATION OF THE ATSAC SYSTEM MUST OCCUR WITHIN FIVE (5) WORKING DAYS AFTER SHUT DOWN.
- REGULAR TRAFFIC SIGNAL CONTROL SHALL BE MAINTAINED FROM 6:00 A.M. TO 9:00 A.M. AND 3:00 P.M. TO 7:00 P.M. ON WEEKDAYS, EXCEPT NATIONAL HOLIDAYS. FLASHING DEACTIVATION AND ACTIVATION OF SIGNALS SHALL BE ACCOMPLISHED ONLY BY AN LADOT TRAFFIC SIGNAL ELECTRICIAN. ALL ARRANGEMENTS TO DEACTIVATE SIGNALS SHALL BE MADE 24 HOURS IN ADVANCE BY CONTACTING THE LADOT TRAFFIC SIGNAL DEDICATED LINE AT (213) 485-9161 BEFORE 9:00 A.M. ON NON-HOLIDAY WEEKDAYS. THE LADOT PROJECT NUMBER MUST BE GIVEN AT THIS TIME. THE CONTRACTOR WILL BE CHARGED FOR ALL ELECTRICAL AND TRAFFIC CONTROL SERVICE PROVIDED BY LADOT.
- ARRANGEMENTS FOR OBTAINING ANY MATERIALS IDENTIFIED TO BE SUPPLIED BY LADOT SHALL BE MADE TEN (10) WORKING DAYS IN ADVANCE BY CONTACTING THE LADOT FIELD OPERATIONS DIVISION AT (213) 928-9603. HOWEVER, TRAFFIC SIGNAL CONTROLLERS REQUIRE SIXTY (60) WORKING DAYS ADVANCE NOTICE AND MUST BE PICKED UP WITHIN THIRTY (30) WORKING DAYS AFTER NOTIFICATION. CONTACT LADOT SIGNAL SHOP AT (213) 473-8468 TO COORDINATE CONTROLLER DELIVER AND/OR PICKUP.
- ALL IDENTIFIED TRAFFIC SIGNAL EQUIPMENT SHALL BE RETURNED TO LADOT. ARRANGEMENTS FOR RETURNING IDENTIFIED EQUIPMENT TO LADOT SHALL BE MADE FIVE (5) WORKING DAYS IN ADVANCE BY CONTACTING THE LADOT MATERIAL SERVICES DIVISION AT (213) 928-9636.
- ALL EXISTING TRAFFIC CONTROL SIGNING SHALL BE MAINTAINED WITH STANDARD SIGN BRACKETS BY THE CONTRACTOR. EXCEPT WHERE OTHERWISE INDICATED, EXISTING LARGE STREET NAME SIGNS ON MAST ARM TYPE STANDARDS SHALL BE RELOCATED FROM THE VERTICAL POLE TO THE MAST ARM PER LADOT STANDARD DRAWING NO. S-457.0 AND S-486.0. THE CONTRACTOR SHALL COORDINATE WITH LADOT SIGN SHOP AT (213) 473-7954 FOR ANY REQUIRED LARGE STREET NAME SIGNS. ANY TRAFFIC CONTROL SIGNING DAMAGED OR LOST BY THE CONTRACTOR SHALL BE REPLACED AT THE CONTRACTOR'S EXPENSE. SIGNAL CONTRACTOR SHALL INSTALL MAST ARM MOUNTED SIGNS. FOR THE INSTALLATION OF A STREET NAME SIGN ON A TYPE 1 POLE, THE CONTRACTOR SHALL FURNISH AND INSTALL A POLE EXTENSION AS NEEDED.
- THE CONTRACTOR SHALL FURNISH AND INSTALL, AS SHOWN ON THE PLANS, ALL TRAFFIC SIGNAL EQUIPMENT SUCH AS STANDARDS, MAST ARMS, SIGNAL HEADS, AND OTHER EQUIPMENT AS REQUIRED. ALL SUCH EQUIPMENT SHALL BE NEW. ALL VEHICLE HEAD EQUIPMENT SUPPLIED BY THE CONTRACTOR SHALL HAVE 1-1/2 INCH DIAMETER PIPE FIT MOUNTING HARDWARE, INCLUDING ALL TOP POST MOUNT HEADS. PED HEAD MODULE REPLACEMENTS SHOWN ON THE PLAN SHALL REQUIRE A COMPLETE INSTALLATION, INCLUDING NEW PED HEAD AND TERMINAL COMPARTMENT.

**RESTORATION TO PRE-PROJECT CONDITION TRAFFIC SIGNAL PLAN**

REVIEWED	April 18, 20 22	ACCEPTED	April 18, 20 22
<b>AS BUILT</b> Date of Installation: _____ LADOT Inspector: _____ Condition As Of: _____ LADOT Engineer: _____ District: WEST VALLEY		CITY OF LOS ANGELES <b>DEPARTMENT OF TRANSPORTATION</b> SELETA J. REYNOLDS, General Manager  <b>FOOTHILL BLVD. &amp; HUBBARD ST.</b> Drawing No. 28320-2022 Intersection No. 28320 Project No. PROPC000 A-5865 A-6285 28320-FOOTHILL 1-014	
DATE	08-19-21	DATE	
BY	EZ	DATE	
TIMING	DISTRICT	DATE	
ATSAC	ATSAC CAMERA	DATE	
REVISION	DESCRIPTION	DATE	